



## Tomboy III

### Hardy Commodore 42

Builder:	Hardy / Andrew N Wolstenholme	Length:	14.2m / 46.58ft
Year:	2011	Beam:	4.36m / 14.3ft
Engines:	Caterpillar C7 450hp	Draft:	1.16m / 3.8ft
Speed:	27 knots	Accommodation:	4 Guests
Engine Hours:	185	Location:	United Kingdom

**Price: GBP 425,000 inc VAT**



# Tomboy III



**MOORE YACHTS Limited**

Lake Yard Marina, Lake Drive, Hamworthy, Poole, Dorset, BH15 4DT, United Kingdom

telephone +44 (0)1202 684641 email [info@mooreyachts.com](mailto:info@mooreyachts.com) web [www.mooreyachts.com](http://www.mooreyachts.com)

Company Registration Number 5306479 VAT Registration Number GB 867 1246 09 FCA Registration Number FCA – FRN738765





# Tomboy III



**MOORE YACHTS Limited**

Lake Yard Marina, Lake Drive, Hamworthy, Poole, Dorset, BH15 4DT, United Kingdom

telephone +44 (0)1202 684641 email [info@mooreyachts.com](mailto:info@mooreyachts.com) web [www.mooreyachts.com](http://www.mooreyachts.com)

Company Registration Number 5306479 VAT Registration Number GB 867 1246 09 FCA Registration Number FCA – FRN738765





# Tomboy III



## MOORE YACHTS Limited

Lake Yard Marina, Lake Drive, Hamworthy, Poole, Dorset, BH15 4DT, United Kingdom

telephone +44 (0)1202 684641 email [info@mooreyachts.com](mailto:info@mooreyachts.com) web [www.mooreyachts.com](http://www.mooreyachts.com)

Company Registration Number 5308479 VAT Registration Number GB 867 1246 09 FCA Registration Number FCA - FRN738765





# Tomboy III



**MOORE YACHTS Limited**

Lake Yard Marina, Lake Drive, Hamworthy, Poole, Dorset, BH15 4DT, United Kingdom

telephone +44 (0)1202 684641 email [info@mooreyachts.com](mailto:info@mooreyachts.com) web [www.mooreyachts.com](http://www.mooreyachts.com)

Company Registration Number 5306479 VAT Registration Number GB 867 1246 09 FCA Registration Number FCA – FRN738765





# Tomboy III



## MOORE YACHTS Limited

Lake Yard Marina, Lake Drive, Hamworthy, Poole, Dorset, BH15 4DT, United Kingdom  
telephone +44 (0)1202 684641 email [info@mooreyachts.com](mailto:info@mooreyachts.com) web [www.mooreyachts.com](http://www.mooreyachts.com)

Company Registration Number 5308479 VAT Registration Number GB 867 1246 09 FCA Registration Number FCA - FRN738765





# Tomboy III

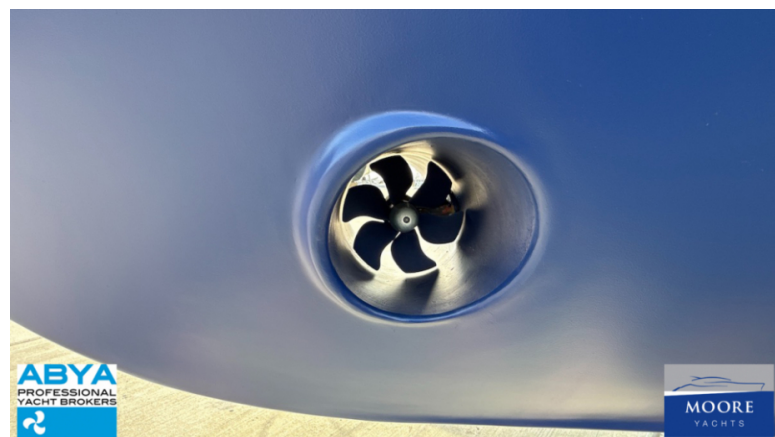

**MOORE YACHTS Limited**

Lake Yard Marina, Lake Drive, Hamworthy, Poole, Dorset, BH15 4DT, United Kingdom  
telephone +44 (0)1202 684641 email [info@mooreyachts.com](mailto:info@mooreyachts.com) web [www.mooreyachts.com](http://www.mooreyachts.com)

Company Registration Number 5306479 VAT Registration Number GB 867 1246 09 FCA Registration Number FCA – FRN738765





## Description

Hardy Commodore 42 (2011 Build / 2011 Model). Twin Caterpillar C7 Common Rail Diesel Engines (450 Hp Each). Moore Yachts are extremely privileged to offer this stunning example of the well renowned Hardy Commodore 42 for sale. Built for a very discerning owner who has enjoyed many boats over the years and wanted to build a new boat without compromise! Maintained regardless of cost and specified to the highest standards, this example of the Commodore 42 enjoyed a mini refit in 2022 by Fox's in Ipswich including new 6mm teak decks, upgraded Raymarine Navigation Suite and full maintenance works. Benefitting from the most desirable Caterpillar engines, "Tomboy III" will cruise comfortably at 22 knots and can achieve a top speed in the region of 27 knots. This example really needs to be seen to appreciate the time and effort that went into her build and viewing is highly recommended. Fully serviced and prepared for the 2025 season and available immediately by her original owner, full title is offered and UK VAT has been paid. Please contact Moore Yachts to discuss this fine opportunity in more detail from a well-established and experienced Yacht Brokerage that are proud members of ABYA and have 30 years of experience in dealing with the complexities of purchasing this type of vessel in an international market....

## Layout / Interior

This example of the Hardy Commodore 42 offers comfortable accommodation for 4 guests. When entering in the interior you are greeted by a spacious saloon with the lower helm area located at the forward section. The helm benefits from twin helm seats located on the port side with a large dash encompassing the engine controls and Raymarine navigation suite. There is an overhead panel that houses all the system controls when underway and the engine instrumentation computers. To starboard there is a well-designed Chart area which has an opening panel allowing extra light into the galley when not using the chart area. Behind the chart area a section of the u-shaped saloon seating lifts to provide a clever double navigation seat for use whilst underway. Forward of the helm area steps lead down to the comprehensive galley which spans across the full beam of the boat with the main galley on the Starboard side and the smaller workstation and fitted fridge and freezer on the port side. The galley is well considered and fitted out with premium equipment for all your culinary needs when aboard. There is a set of twin stainless steel sinks countersunk into the luxury Corian worktops and plenty of storage available. Moving forward you enter the Guest cabin which provides twin berths in the format of a V-Shaped bed, to port there is a wardrobe with shelving and a clever chart storage area above, to starboard is the guest ensuite / day heads comprising of Shower, Techma Toilet system and wash hand basin with hot and cold water and storage below. Moving aft of the saloon you enter the Master bedroom suite with a comfortable double bed located off centre and plenty of storage around the outside of the room. The forward bulkhead houses a wardrobe compartment and a recess to house the flatscreen TV. To Starboard, there is a dressing table and entrance to the ensuite. The ensuite benefits from a walk-in shower with a seat, wash hand basin with hot and cold-water set-in Corian countertops and a Techma toilet system. The interior is finished with classic and stylish wood cabinetry throughout, champagne vinyl headlining's, Alcantara saloon seating and the overall look is complimented with an array of soft furnishings, curtains and ocean-air blinds in the Saloon. The external area benefits from generous side decks to provide a full walkaround experience, aft deck with seating and storage, flybridge with upper helm and plenty of seating / storage and a large bathing platform for easy access to the sea for all your water-based activities.



## Specification

- Full walkthrough video available on our YouTube Channel at: <https://youtu.be/w0g7c7HnR3w>
- Update Video showing Hull and preparation for 2025 season available on our YouTube Channel at: <https://youtu.be/Z8YbxxGeGVk>
- Over 250 Pictures available by separate request.

## General Equipment & Options:

- *Commissioned in June 2011*
- *Upgraded Caterpillar C7 diesel engines with Twin Disc electronic engine controls*
- *Teak decks side, aft & flybridge - Replaced in 2022 by Fox's (Ipswich) in 6mm teak*
- *Vetus hydraulic bow & stern thrusters*
- *Seastar hydraulic steering system*
- *Upgraded hydraulic pump*
- *Upgraded hydraulic windlass*
- *Stainless steel anchor with 60 metres chain*
- *Eltrim trim tab system*
- *Air conditioning throughout*
- *Eberspacher Hydronic 10 heating system throughout*
- *Generator - Fisher Panda AGT DC Generator 4kW*
- *Victron Inverter - Supplies oven, hob, microwave, immersion heater, TV & 240v sockets*
- *Victron Skylla 80 Amp battery charger system*
- *240V shore power system*
- *24V DC System*
- *Sea Fire FM200 engine room fire extinguisher system*
- *6 x Engine / Domestic Batteries (150AH) - 1 x Generator Battery (70 AH)*
- *Electronic Devices Limited bilge pump system with 4 electric bilge pumps*
- *Whale manual bilge pump*
- *Hot and cold-water system with calorifier*
- *Techma Marine toilets*
- *Grey water holding tank system (390 Litre Capacity)*
- *Hydraulic folding radar arch with upgraded hydraulic hoses*
- *Raymarine Axiom Pro 16 RVX multi-function display x 4 (2 at each helm)*
- *Raymarine 4kW 48 inch HD digital open array radar scanner*
- *Raymarine ST70 Autopilot control (1 at each helm station)*
- *Raymarine SPX-30 Autopilot system with type 1 hydraulic pump*
- *Raymarine ST70 colour displays*
- *Raymarine arm anemometer transducer*
- *Raymarine speed/depth/temp transducer*
- *Raymarine Cam 100 mast mounted camera*
- *Raymarine Ray 240E DSC/VHF with remote station*
- *Raymarine AIS receiver linked to plotters*



- Raymarine Raystar 125GPS
- Raymarine Seatalk Backbone NG backbone kit
- Plastimo compass (1 at each helm station)
- Horn
- Sony flatscreen tv in Saloon with electrically operated rise and fall system
- Humax Freesat+ HDR
- Raymarine satellite system with dome
- Flatscreen tv in Master Cabin
- Glomex TV antenna system
- Pioneer stereo system with speakers
- Waeco Fridge and freezer in galley
- Neff Microwave in Galley
- Neff Oven
- Bosch induction hob
- Corian galley worktops
- Modified chart table area (wooden "sunroof" to give galley more light)
- Chart locker in top of hanging locker in forward cabin
- Waeco top entry fridge in saloon
- KAB suspension helm and navigator seats
- Duro twin Arm Windscreen Wipers with Washer Jets (Variable Speed)
- Electric Window Demisters built into glass
- Extractor fans in both heads
- Aft deck floodlight
- Grab handle on mast by steps up to flybridge
- Grab handle & shelf on back of flybridge helm seats
- Centre aft deck locker
- Aft deck backrest cushions
- Courtesy Deck lights
- Forward bunk infill to make double bed
- Bathing platform
- Bathing ladder
- Hot & cold transom shower
- Outboard motor bracket
- Stainless steel fender baskets
- Custom made bow cleats in stainless steel by windlass
- Ensign staff
- Warps & fenders
- Plastimo Cruiser 6 Liferaft (New 2023)
- Lifebouy and light with floating line
- Upgraded cover set for flybridge and windows (New 2022)
- This example of the Iconic Hardy 42 has been Fully prepared for the 2025 season including full exterior polish, full antifoul removal and re-applied with epoxy coat underneath, new skin fittings and will be serviced for the new owner to enjoy....



## Manufacturer Provided Descriptions:

Blending elegant looks, enhanced systems engineering and luxurious accommodation, the Hardy 42, designed by Andrew Wolstenholme, has long been the serious cruiser's choice and offers a smooth ride at more than 25 knots, even in adverse weather conditions.

Wide, safe, walkaround decks with a generously proportioned aft deck and flybridge provide plenty of outdoor living space for relaxing and taking in the view.

### Deck:

- Enclosed by bulwarks and solid handrails round the whole boat that can comply with the MCA workboat code and incorporate fender baskets (optional side and aft deck concealed lights)
- windlass on foredeck with local controls at both the lower and flybridge helm positions (option hydraulic)
- Anchor and 60m. chain cable
- Large lazarette locker below lower aft deck plus outboard bracket above
- Hinged access gates through the rails on either side for access ashore and aft onto the bathing platform

### Lower Helm Area:

- With twin KAD Suspension helm seats
- Fold-up section of settee providing 2 further pilot seats
- Sliding doors providing access to the side decks either side
- Engine and thruster controls, navigation and communication electronic equipment
- Overhead electrical control console and a dedicated chart table with red lights above

### Accommodations:

#### Central Deck Saloon:

- Comfortable seating for 6 or more
- Dining table with folding leaves and an adjustable height central pillar
- Various lockers units with an optional built-in TV on a retractable bracket
- Bottle locker
- Glasses locker
- Dehumidifier locker etc
- Dual voltage fridge/freezer unit (optional top entry)
- Daily access hatch to engine room
- Complete sole may be removed for more extensive maintenance access round each engine and gearbox and to the stern glands



## Aft stateroom:

- Queen-sized double bed
- Extensive lockers and drawer units
- Dressing table with mirrors and suitable lighting
- Optional TV built into forward bulkhead
- Aft heads attached to aft stateroom with separate shower compartment and curved sliding door
- Manual or electric toilet and washbasin set in a dedicated moulded unit

## Forward cabin:

- Full length and width 'V' berths (optional double conversion)
- 2 hanging locker, lockers below side decks either side and lockers below and between the berths
- Access to the chain locker via a watertight door behind the mirror

## Forward heads:

- Off the forward cabin with optional separate shower compartment and curved sliding door
- Manual or electric toilet and washbasin set in a dedicated moulded unit

## Galley:

- Electric 4-burner ceramic hob (option induction hob)
- Electric fan oven
- Built in microwave (option combined oven and microwave)
- Double sink and mixer tap
- Extensive worktop (option Corian) with stainless steel splash back
- Various lockers and drawers
- General lighting and dedicated lighting above each worktop
- Optional deck head opening through the chart table to give additional light in port
- Dual voltage fridge/freezer
- Waste bin below steps

## Flybridge:

- Lockers on 3 side fitted with removable cushions and a Perspex wind shield covering the forward two thirds of the flybridge.
- Console on forward side or centre of flybridge with engine, thruster, trim tab and steering controls, plus duplicates of the electronic equipment at the lower helm
- Twin adjustable helm seats (optional position for seats and console further aft)
- Hinged mast with radar scanner, aerials, sensors etc

## Bathing Platform:

- Teak slats and an extending MOB/bathing ladder



# Tomboy III

## Layout

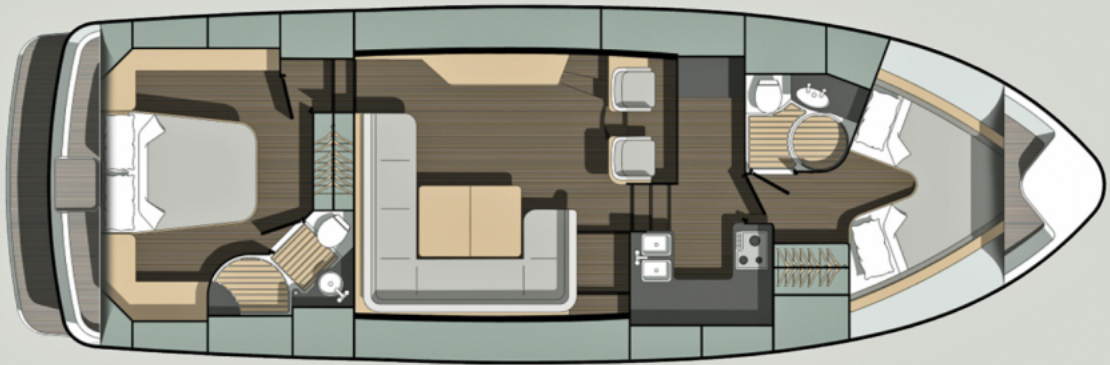
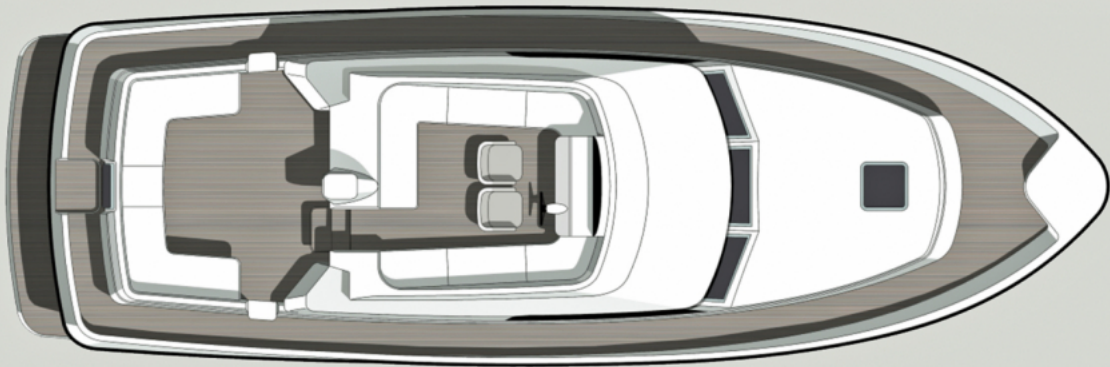
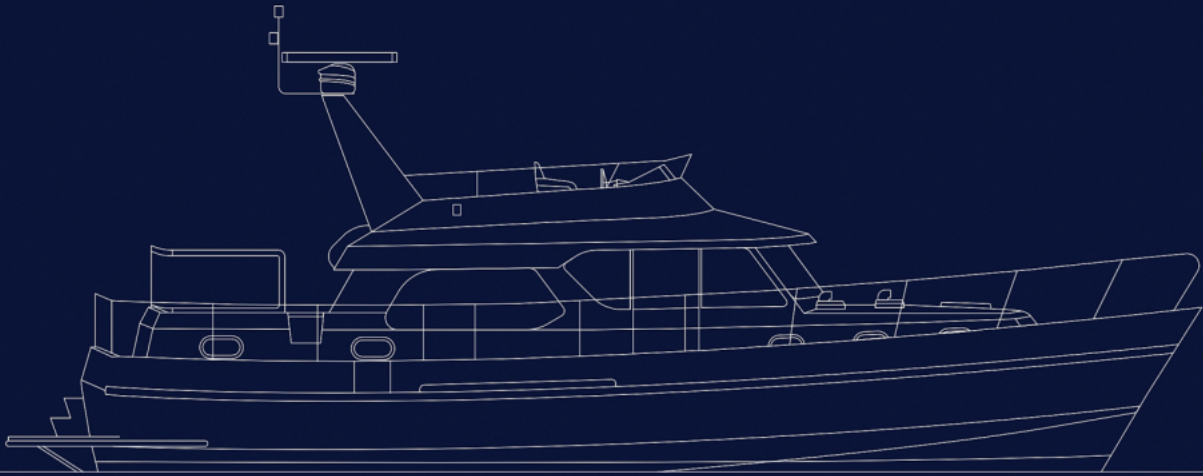

### Disclaimer

The Company offers the details of this vessel in good faith but cannot guarantee or warrant the accuracy of this information nor warrant the condition of the vessel. A buyer should instruct his agents, or his surveyors, to investigate such details as the buyer desires validated. All prospective purchasers should be aware that the "Manufacturers Model Year" varies from builder to builder and does not necessarily correspond to the vessels year of build. This vessel is offered subject to prior sale, price change, or withdrawal without notice. In this case we are acting as Brokers only. Whilst every care has been taken in their preparation, the correctness of these particulars is not guaranteed. The particulars are intended only as a guide and they do not constitute a term of any contract. A prospective Buyer is strongly advised to check the particulars and where appropriate at his own expense to employ a qualified Marine Surveyor to carry out a survey and/or to have an engine trial conducted which if conducted by us shall not imply any liability for such engine on our part. Life-saving appliances do not form part of the inventory and it is for the buyer to ensure they are in date and suitable for his purposes.

### MOORE YACHTS Limited

Lake Yard Marina, Lake Drive, Hamworthy, Poole, Dorset, BH15 4DT, United Kingdom

telephone +44 (0)1202 684641 email [info@mooreyachts.com](mailto:info@mooreyachts.com) web [www.mooreyachts.com](http://www.mooreyachts.com)

Company Registration Number 5306479 VAT Registration Number GB 867 1246 09 FCA Registration Number FCA – FRN738765